

# Bosch 225lph In Tank Fuel Pump 0580464100

**Brand:** Bosch Motorsport  
**Product Code:** BOS0580464100  
**Availability:** In Stock  
**Weight:** 1.00kg  
**Dimensions:** 15.00cm x 15.00cm x 5.00cm

**Price: \$260.00**

## Short Description

A great choice for in tank EFI installations and also as a handy upgrade for many OEM fuel tank modules.

## Description

- >225l/h @ 4bar
- In-tank pump
- 38mm diameter body

**BOSCH**

## >225l/h @4bar In-tank Fuel Pump

0 580 454 100



- >225l/h @ 4bar
- In-tank pump
- 38mm diameter body
- Draws ~12.5A @ 5.5bar
- Male outlet fitting to suit 8mm ID
- 11mm OD inlet port

### Electrical Connection

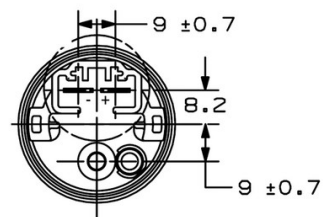

### Dimensions

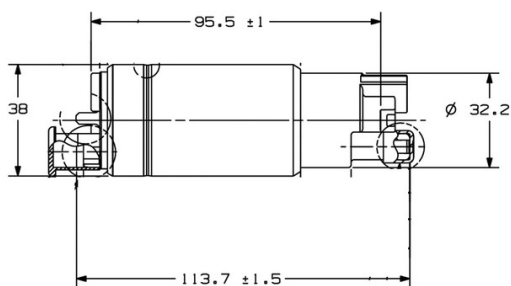

### Characteristic Data

See description. For further details contact Bosch Motorsport

### Notes

Robert Bosch (Australia) Pty Ltd | [www.bosch-motorsport-shop.com.au](http://www.bosch-motorsport-shop.com.au) | [motor.sport@au.bosch.com](mailto:motor.sport@au.bosch.com) | [www.facebook.com/BoschMotorsportAustralia](https://www.facebook.com/BoschMotorsportAustralia)

## Product Gallery

